

Assembly Instruction

A 	B 	C 	D 
Back	Base	Motor Remote	Transformer

1

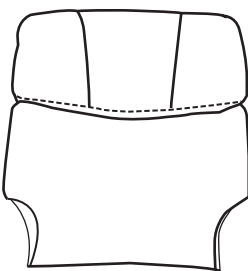
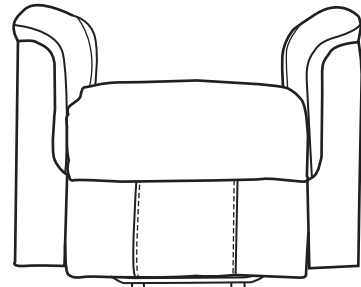
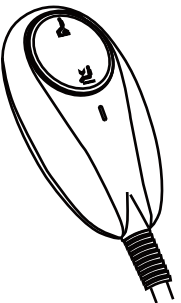
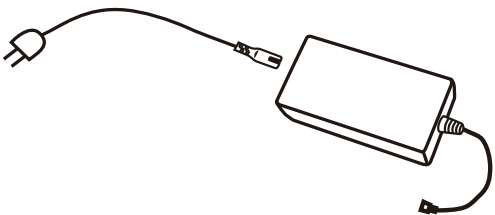
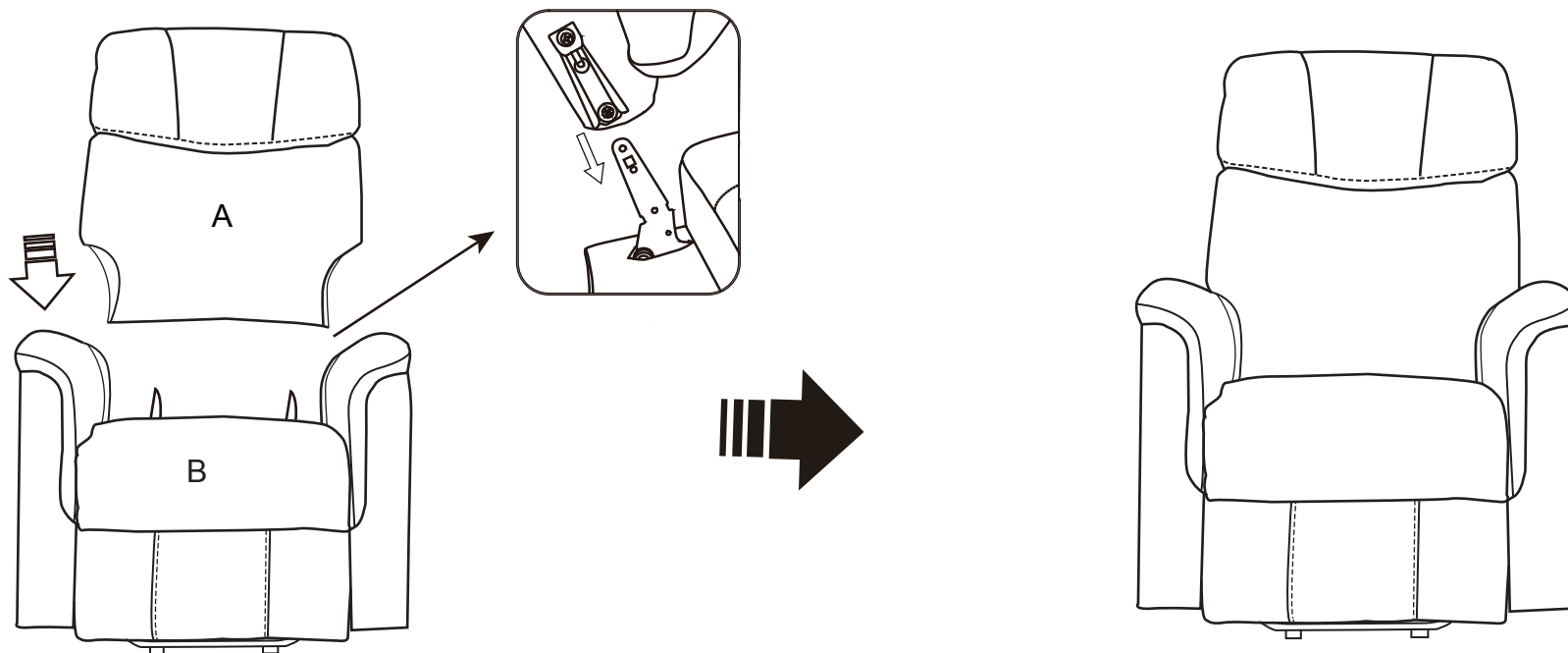

Insert the back(A) on the Base(B)
Gently push down until the back locks into
the position.

Assembly Instruction

2

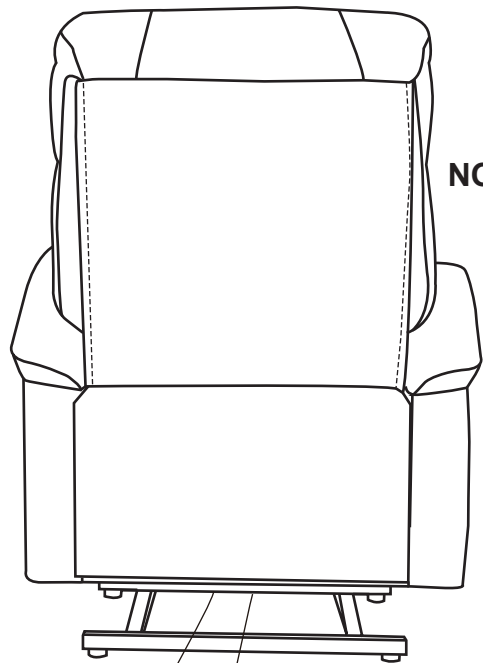

NO ①: wire connect the motor and the lift remote.

NO ②: wire connect the motor and the power source.

Motor Remote (C)

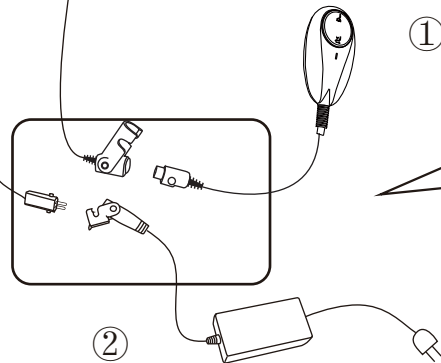

Power Source(D)

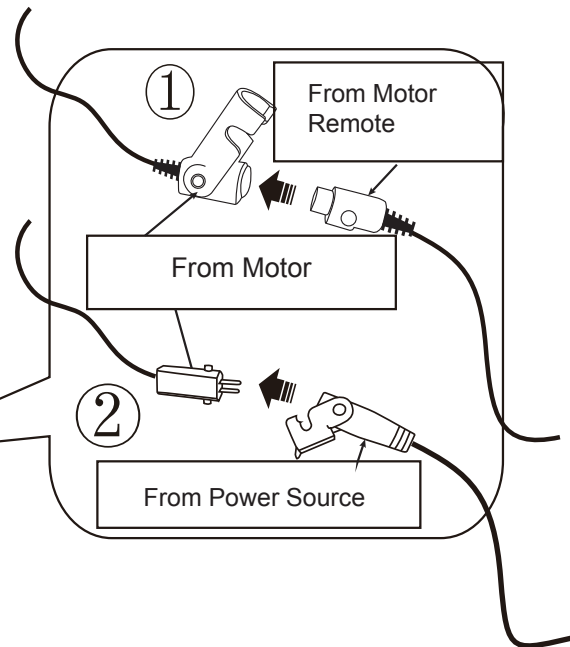

COMPLETE!

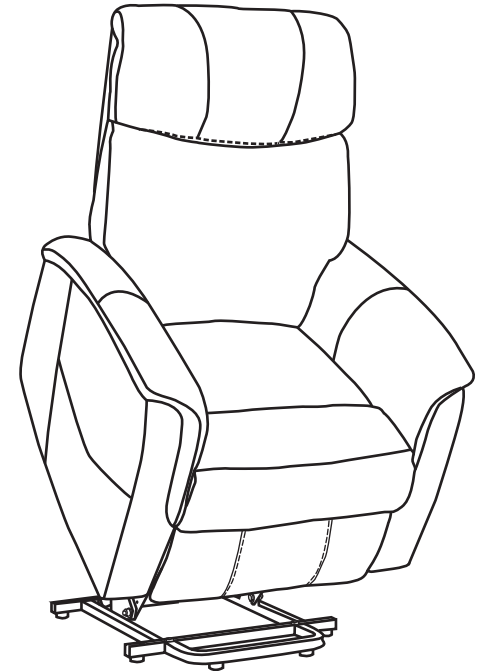

Light on the remote is illuminated, and use the remote to control the chair to recline and lift to different positions